

[www.jeffreygross.co.uk](http://www.jeffreygross.co.uk)

CARDIFF

VALE

CAERPHILLY

BRISTOL



*Newport Road*

RUMNEY





Comments by Jon Hooper-Nash



**Property Specialist**  
**Jon Hooper-Nash**  
Director  
[jon@jeffreycross.co.uk](mailto:jon@jeffreycross.co.uk)

## 828 Newport Road (Annex)

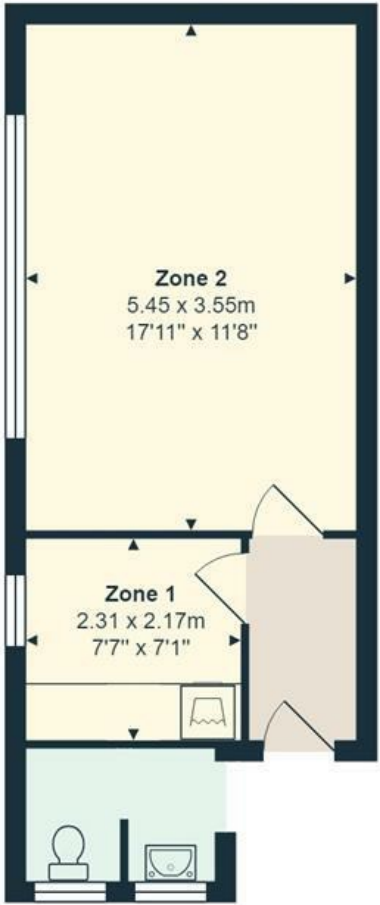

Total Area: 30.5 m² ... 328 ft²

All measurements are approximate and for display purposes only

*Spacious, former bake house which could be used for a multitude of business types.*

Comments by the Homeowner





# Newport Road

*Rumney, Cardiff, CF3 4LH*

PCM

£500 PCM



0 Bedroom(s)



1 Bathroom(s)



328.00 sq ft



Contact our  
*Penylan Branch*  
02920 499680

JeffreyRoss are delighted to offer this spacious commercial unit for rent in the popular retail area of Newport Road, opposite Llanrumney Avenue and the bustling retail areas in Rumney. The unit is situated to the rear of 828 Newport Road and is accessed via rear lane. Internally the property offers good space with additional storage area, accessed via open ladders. The property is very well-presented and versatile to cater for the needs of a host of different business types.

Lease lengths and terms are flexible.

Please call Jon for more information on 02920499680.

Please note, administration fees may apply, please enquire within for more information.







CARDIFF

VALE

CAERPHILLY

BRISTOL

[www.jeffreygross.co.uk](http://www.jeffreygross.co.uk)



